

Product Bulletin for SmartlockPro® Slim GFCI Receptacles



Slim is in.

New SmartlockPro® Slim GFCIs Install Easily

Industry-leading quality, professional grade lockout action, and the slimmest profile on the market make SmartlockPro Slim GFCIs the smartest choice in ground fault circuit interrupter protection. Faster and easier to install in any wallbox because depth is reduced, the slim GFCIs flush mount to the wall with minimal protrusion for a sleek, finished look. Enhanced features include external back wiring for positive indication the wire is properly seated, exceptional resistance to wire pullout and the ability to withstand high torque.

Tamper-Resistant to meet 2008 NEC® Requirements for new or renovated residential construction.



Takes up to 25% less space in the wallbox vs. other GFCIs



Typical GFCI

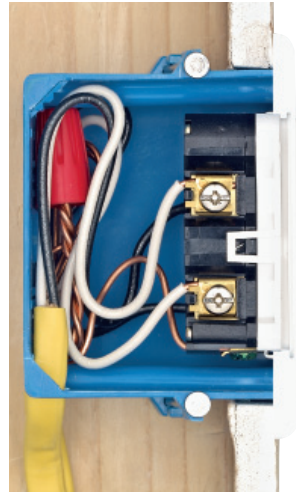

New SmartlockPro Slim GFCI

Applications

Residential – Kitchen, bathrooms, garages, basements, laundry rooms, wet sink, and other wet locations around the home

Educational Facilities – Classrooms, restrooms, laboratories, dormitories and kitchens

Airports – Public bathrooms, general use and maintenance areas

Restaurants, Lodging and Retail Malls – Public bathrooms, general use and maintenance areas

Commercial Offices – Bathrooms, basement areas, hallways and kitchen facilities

Public Areas – Wherever receptacles are required near wet or damp locations

For a complete list of GFCI applications and code requirements, visit leviton.com/gfci

The SmartlockPro® Protection Advantage

Patented Reset Lockout

The Reset Lockout feature provides an end-of-life indication and prevents reset if a SmartlockPro GFCI is damaged so that it cannot respond to a ground fault. Competitive GFCIs may allow reset even if they are no longer providing protection.

The SmartlockPro RESET button will not engage if:

- The GFCI is miswired due to reversal of the line and load leads
 - Delivery of power to feed-through terminal and face will be blocked
- There is no power being supplied to the GFCI
- The GFCI cannot pass its internal test

LED Indicator for Line-Load Reversal

If a SmartlockPro GFCI is miswired during installation (line-load reversal) it cannot be reset. The green LED will be ON to indicate a line-load reversal. Once the GFCI is properly wired and can be reset, the LED acts as a power indicator that remains ON as long as the GFCI is operating correctly and providing power. Unlike some other designs that employ a one-time feature, Leviton's line-load reversal protection is not lost or disabled after initial installation.

SmartlockPro Dual-Function LED Indicators

	LED Indication	Reset Status	Reason
During initial installation	ON	Will not reset	Line and load leads are reversed
	OFF	Press RESET and LED comes ON	GFCI is wired and operating correctly
During normal operation	ON	GFCI is reset	Power is ON
	OFF	GFCI is tripped	Power is OFF

Features and Benefits

Slim, Shallow Design

- Reduced depth makes it easier to install in any electrical box, even shallow ones
- Provides up to 25% or more space in the wallbox vs. other GFCIs
- Terminals allow for easy wiring options – back and side wire capable
- External back wire clamps provide visual indication of proper clamping
- Standard brass self-grounding clips
- Withstands high torque and resists wire pullout

General

- Trip threshold meets or exceeds UL requirements for tripping time
- Improved immunity to high frequency noise reduces nuisance tripping
- Advanced electronics provides superior resistance to electrical surges and over-voltages
- Silver alloy contacts
- Impact-resistant thermoplastic cover and body
- Expanded wiring options with external wiring clamps
- Dual function LED offers indication of line/load reversal and power availability
- One-piece T-design trip latch mechanism provides efficient operation
- Available in 15A and 20A versions, all with Fed Spec rating
- TEST and RESET button colors match device face
- Compatible with all Decora® devices and wallplates; available in select Decora colors
- Limited Two-Year Warranty

Tamper-Resistant

- TR symbol assures compliance with NEC® Section 406.1 mandating that all 15A and 20A receptacles installed in dwelling units be listed as tamper-resistant
- Shutter mechanism inside the receptacle blocks access to the contacts unless a two-prong plug is inserted, helping ensure hairpins, keys, etc., will be locked out

Patented Lockout Action

- Automatically tests the GFCI every time the RESET button is pushed in. The GFCI will not reset if its circuit is not functioning properly
- Blocks the RESET button if GFCI protection has been compromised, reducing the possibility of end-users incorrectly assuming that a reset GFCI is providing ground fault protection when it is not
- Patented bridge contact provides individual sets of contacts for GFCI receptacle face and downstream receptacles

Agency Standards and Compliance

- Meets or exceeds the latest UL requirements including end of life and disconnection of power from GFCI face on line-load reversal
- UL Standard 943 Class A (GFCI) and 498 (Receptacles)
- UL Listed (File #E-48380)
- CSA Certified (File #LR-57811)
- NOM Certified (File #057)
- Meets Federal Specification W-C-596G

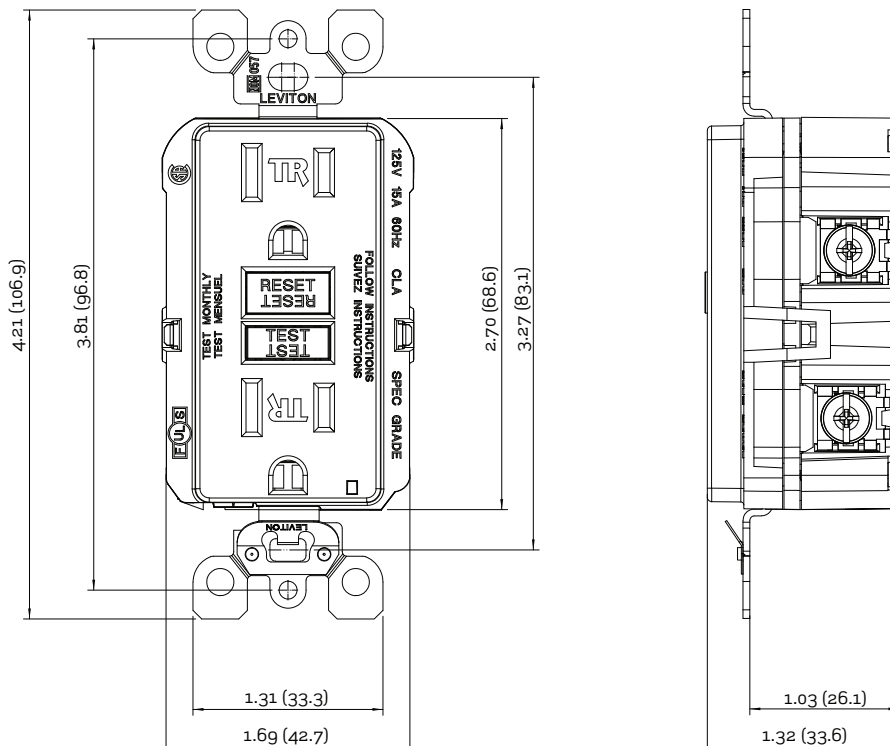

Material Characteristics

- Environmental: Flammability UL-94 V2 Rating
- Operating Temperature: -35°C to 65°C
- Material: Face, Polypropylene; Body, Polycarbonate



Ordering Information

**SmartlockPro® Slim GFCI Receptacles*
Spec Grade – Back and Side Wired**

Description	Rating	Cat. No.	Color
Tamper-Resistant GFCI with LED Indicator	15A-125V @ Receptacle, 20A-125V Feed-Through NEMA 5-15R 	X7599-W X7599-I X7599-T X7599-GY X7599-E X7599	White Ivory Light Almond Gray Black Brown
Tamper-Resistant GFCI with LED Indicator	20A-125V @ Receptacle, 20A-125V Feed-Through NEMA 5-20R 	X7899-W X7899-I X7899-T X7899-GY X7899-E X7899	White Ivory Light Almond Gray Black Brown

Note: NAFTA Compliant SmartlockPro Slim GFCIs are available for projects subject to the provisions of the North American Free Trade Agreement.

* This product is covered by U.S. Patents Nos. 6,040,967; 6,246,558; 6,282,070; 6,381,112; 6,437,953; 6,646,838, 6,657,834, 6,864,766, 6,944,001, 7,336,458, 7,400,479; 7,463,124; 6,900,972; 7,082,021; 6,788,173; 7,355,117; as well as foreign patents CA 2,425,810; MX 234,458; MX 251,584; HK 1,059,844; CN ZL01819728.0; CN ZL200510089460.7.

SmartlockPro and Decora are registered trademarks of Leviton Manufacturing Co., Inc.
NEC is a registered trademark of the National Fire Protection Association, Inc.

Leviton Manufacturing Co., Inc.

201 North Service Road, Melville, NY 11747-3138
Telephone: 1-800-323-8920 FAX: 1-800-832-9538
Tech Line (8:30AM-7:00PM E.T. Monday-Friday): 1-800-824-3005

Leviton Manufacturing of Canada, Ltd.

165 Hymus Boulevard, Pointe Claire, Quebec H9R 1Eg
Telephone: 1-800-469-7890 FAX: 1-800-563-1853

Leviton S. de R.L. de C.V.

Lago Tana 43, Mexico DF, Mexico CP 11290
Telephone: (+52) 55-5082-1040 • www.leviton.com.mx

Visit our Website at: www.leviton.com/gfci

