

**NEW**

# Low Profile Furred Wall Box® Use with Your Own Cover

*Add Arlington Box Extenders for Broader Application and Use*

## Base Assemblies for 1/2" Wall Thickness & Standard Depth Device

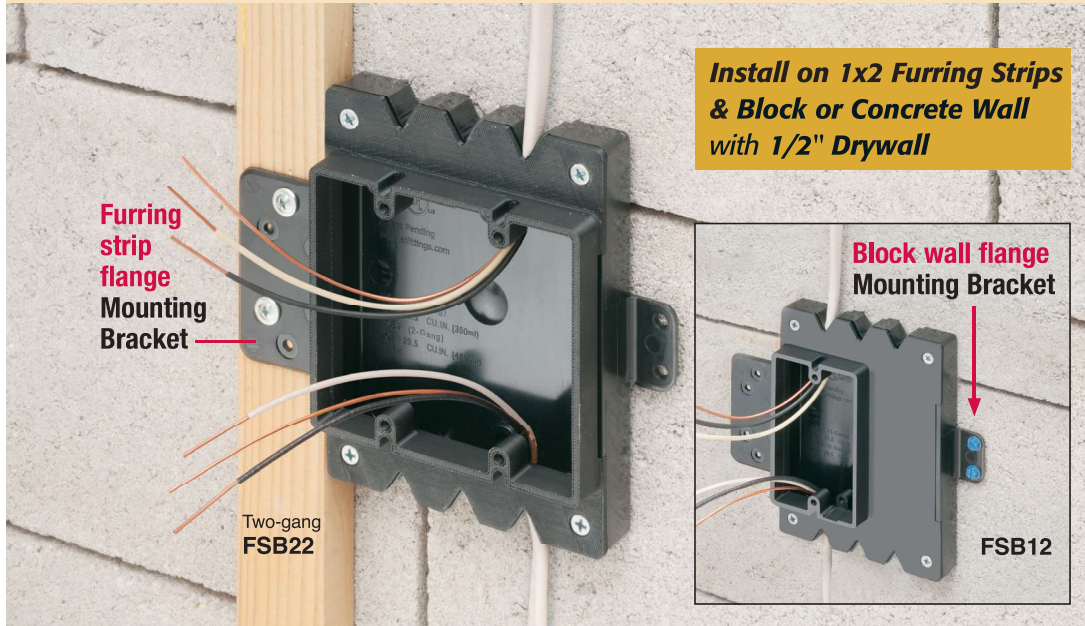

Uses Standard Wall Plates



### *Eliminates installation steps*

**NO** new furring strips  
**NO** wall break out  
**NO** sealing hole

<sup>1</sup> \$60/hour fully burdened labor rate

**SAVE**  
**15 MINUTES**  
and **\$15.00<sup>1</sup>**  
per BOX



*Our BOX EXTENDERS broaden applications. See below for specific conditions.*

### **1** Add Box Extenders with this condition:

Overall Total Wall Layer Thickness **GREATER** than 1/2"



Example:  
3/4" thick layer  
(1/2" wallboard  
and 1/4" tile)



### **2** Add Surface Box Extenders with these conditions:

– 1/2" Drywall  
– Deep Depth Wiring Devices



Arlington's **FSB version** Furred Wall Box®, saves time – and makes challenging outlet box installation easy!

These new **single** and **two-gang** low profile **assemblies with 1/2" raised box covers** combine with other Arlington products to offer **installation solutions** for varying wall thicknesses from 1/2" to 1-1/2" thick and varying device depths.

Designed for use with existing 1x2 drywall furring strips – FSB series outlet boxes can also be mounted on a concrete block wall *between furring strips* so installers can place the box/outlet where it's needed.

### **Eliminates installation steps**

#### **Fast, easy installation**

There's **NO NEED** to break out concrete block. **NO NEED** to install separate furring strips. And **NO NEED** to seal the block wall breakout and box.

- Integral cable securement and retention – No pullout!
- Accommodates standard and GFCI devices in varying depths – Uses standard decorator-style wall plates
- Box volume (cu. in.)  
Single gang FSB12 - 17.0 (280 ml)  
Two-gang FSB22 - 20.5 (336 ml)
- High strength –  
Withstands freeze/thaw cycles



Patent pending



**Arlington®**

**NEW!**

# Low Profile Furred Wall Box® Use with Your Own Cover

*Add Arlington Box Extenders for Broader Application and Use*

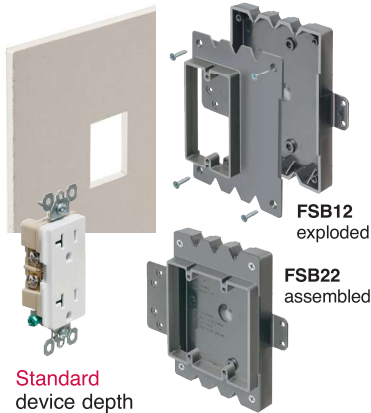

**FSB12 & FSB22 Base Assemblies** for **1/2" Wall Thickness** & **STANDARD** Depth Device  
Install on 1x2 Furring Strips and Block – or Concrete Wall with 1/2" Drywall

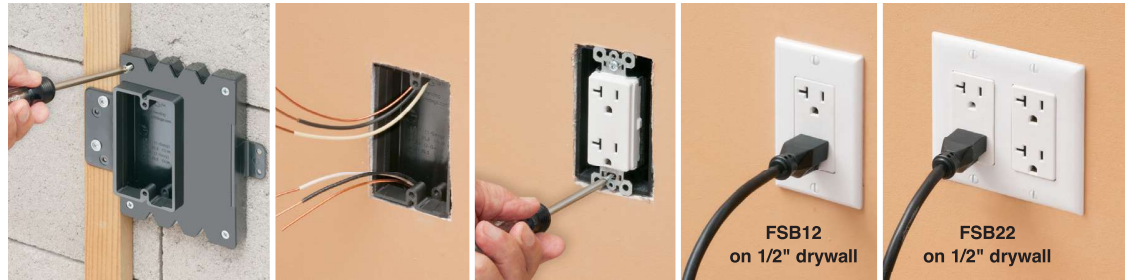

*Add our BOX EXTENDERS for these specific conditions.*

**1** Is **Total Wall Layer Thickness**

1/2" drywall  
+ tile

**GREATER  
THAN 1/2"?**

**YES**

Add  
BE1  
or BE2



Wall Thickness **GREATER** than 1/2" up to 1-1/2"

**2** Using a **Deep Depth Device?**

(GFCI, USB, Dimmer)

**YES**

Add  
BES1  
or BES2



**1/2" Wall Thickness • DEEP Device**



**Arlington**

Catalog Number	UPC/DEI/NAED Mfg. #018997	Description Furred Wall Box Assembly • Box Extenders	Unit/Std Pkg
<b>FSB12</b>	99361	One-gang Furred Wall Box assembly w 1/2" raised cover	1/10
<b>FSB22</b>	99362	Two-gang Furred Wall Box assembly w 1/2" raised cover	1/10
<b>BES1</b>	48976	Single gang surface box extender	1/10
<b>BES2</b>	48977	Two-gang surface box extender	1/10
<b>BE1</b>	40160	Single gang box extender	25/25
<b>BE2</b>	48960	Two-gang box extender	25/25

FSB12 and FSB22 kits include (4) screws each

Distributed by



Patent pending

FSB12-22 0125/25M